

B88-M220.01

K1.15S3A

Spindle for high speed pcb sawing

Technical specifications

- High precision steel ball bearings – 2 Pcs.
- Lifetime lubricated, maintenance free
- Output power: Pmax. 1,9 KW
- Output power: S1-100% ED 1,4 KW
- Output power: S6-60% ED 1,6 KW
- Voltage: S1-100% ED 180 V
- Voltage: S6-60% ED 178 V
- Current: S1-100% ED 6 A
- Current: S6-60% ED 6,5 A
- Frequency: max. 667 Hz
- Motor poles: 2 pairs
- Rotation speed: max. 20.000 rpm
- Motor protection: thermistor
- Speed monitoring: transmitter
- Sealing-air
- Housing diameter: 88 x102,5mm (flange)
- Cooling system: none cooled
- Tool change: manual tool change
- Holder for cutting wheel: Ø16 up to 3 mm thickness
- Coupler plug: 8-pole metal incl. cable 1,15m
- Contact by touch (ESD Prevention)
- Weight: 3,6 Kg

Example of design

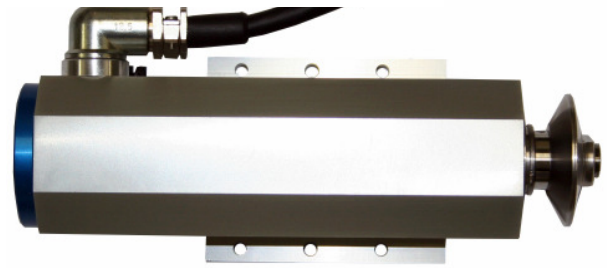

Dimensions

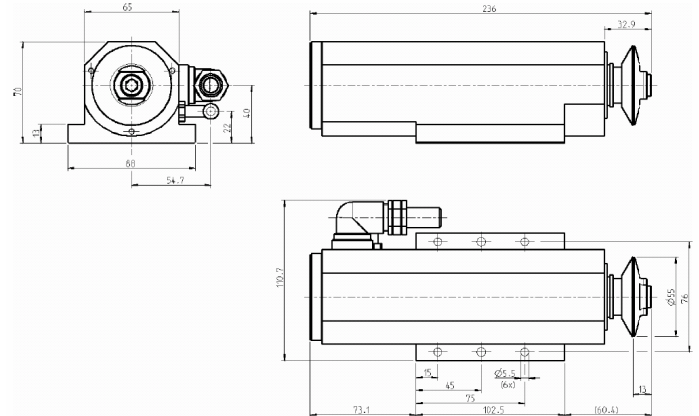

Power-, torque- and speed diagram

