

# KS2-10/80

High-frequency spindle  
Pneumatic direct tool change

**Spindle for high-speed -drilling, -routing,  
-depaneling**

## Technical specifications

- High precision hybrid ball bearings – 2 Pcs.
- Lifetime lubricated, maintenance free
- Output power: Pmax. 1,6 KW
- Output power: S1-100% ED 1 KW
- Output power: S6-60% ED 1,1KW
- Voltage: S1-100% ED 212 V
- Voltage: S6-60% ED 213 V
- Current: S1-100% ED 4,5 A
- Current: S6-60% ED 5 A
- Frequency: max. 1333 Hz
- Motor poles: 1 pair
- Rotation speed: max. 80.000 rpm
- Motor protection: thermistor
- Speed monitoring: transmitter
- Sealing-air
- Housing diameter: 62 mm
- Cooling system: liquid cooled
- Tool change: pneumatic direct tool change
- Clamping range: up to 6 mm
- Coupler plug: 9-pole plastics
- Weight: 3,2 Kg
- Inner taper run out < 1 $\mu$

## Example of design



## Dimensions

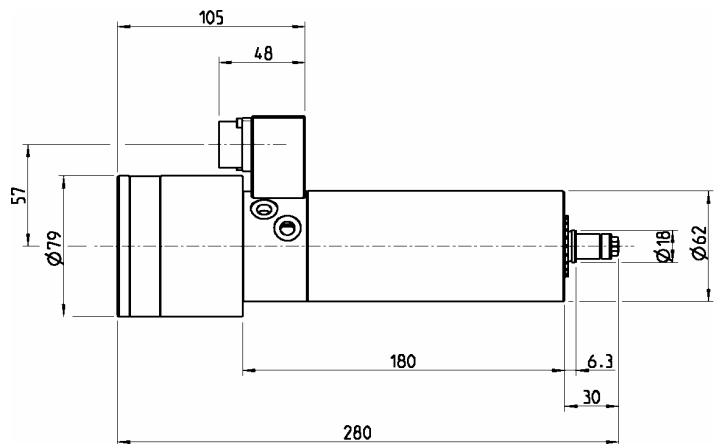

## Power-, torque- and speed diagram

